



Ročno brušenje na stebrnih brusilnih strojih

Brusna plošča F1

D x T x H

ravna brusna plošča



Primer za izpis naročila:

F1 300x30x127

10C60K6VL

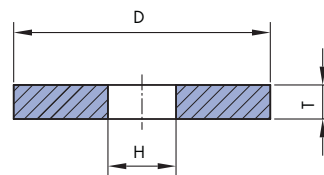

D	T	H
125	10 do 25	22.7, 16, 20
150	10 do 25	16, 20, 25, 32
175	10 do 25	20, 25, 32
200	10 do 25	20, 25, 32, 40
250	10 do 32	20, 25, 32, 40, 51, 76
300	13 do 50	32, 40, 51, 76, 127
350	16 do 50	32, 40, 51, 76, 127, 151
400	20 do 80	40, 51, 76, 127, 152.4, 203
450	20 do 80	76, 127, 152.4, 203
500	25 do 100	76, 127, 152.4, 203
600	32 do 100	127, 152.4, 203, 305

Brusna plošča F5

D x T x H - P x F

ravna brusna plošča -
poglobitev z ene strani



Primer za izpis naročila:

F5 300x50x127-190x20

23A60M7VL

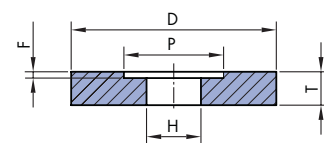

D	T	H	P	F
200	10 do 25	20, 25, 32	110	F = max. T/2
250	10 do 32	51, 76	130	
300	13 do 50	76, 127	190	
350	16 do 50	76, 127	215	
400	20 do 80	127, 152.4	230	
450	20 do 80	127, 152.4	290	
500	25 do 100	127, 152.4	290	
600	32 do 100	127, 152.4	290	

Brusna plošča F7

D x T x H - P x F / G

ravna brusna plošča -
poglobitev z obeh strani



Primer za izpis naročila:

F7 300x50x127-190x15/10

10C60K6VL

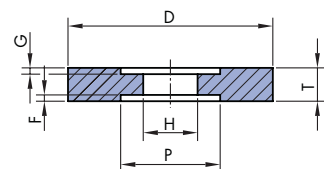

D	T	H	P	F, G
200	20 do 40	20, 25, 32	110	F+G = max. T/2
250	10 do 32	51, 76	130	
300	13 do 50	76, 127	190	
350	16 do 50	76, 127	215	
400	20 do 80	127, 152.4	230	
450	20 do 80	127, 152.4	290	
500	25 do 100	127, 152.4	290	
600	32 do 100	127, 152.4	290	

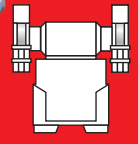

Obdelovani material		Kvaliteta	
		Grobo brušenje	Fino brušenje
Jekla 	Nelegirana jekla Legirana jekla Visokolegirana jekla	11A36P5VL 22A46M5VL 40A60M7VL	11A60M6VL 22A60K6VL 40A60K6VL
Trdine 	Karbidne trdine	10C60K6VL, 11A30P7VL	10C80K6VL
Litine 	Siva litina Jeklena litina Nodularna litina	90C46M6VL, 12A24P4VL 12A36M5VL 41A36L5VL	
Barvne kovine 	Al in zlitine Cu in zlitine	90C46K7VL 90C46K7VL	
Nekovine 	Plastika Keramika	90C46J8VL 90C46J8VL	

