

Zunanje okroglo brušenje

Brusna plošča F1

$D \times T \times H$

ravna brusna plošča

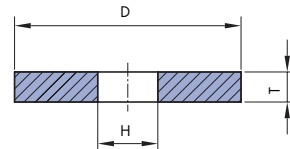

Primer za izpis naročila:

F1 300x30x127

3LA70G5VL

D	T	H
200	10 do 32	13, 16, 20, 25, 32, 40, 51
225	10 do 32	16, 20, 25, 32, 40, 50, 60
250	10 do 32	20, 25, 32, 40, 51, 76
300	10 do 50	32, 40, 51, 76, 127
350	16 do 50	32, 40, 51, 76, 127, 151
400	20 do 80	40, 51, 76, 127, 152.4, 203
450	20 do 80	76, 127, 152.4, 203
500	25 do 100	76, 127, 152.4, 203
600	32 do 100	152.4, 203, 305

Brusna plošča F5

$D \times T \times H - P \times F$

ravna, poglobitev - ena stran

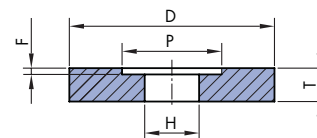

Primer za izpis naročila:

F5 300x50x127-190x20

22A60I12/2SVL

D	T	H	P	F
200	20 do 40	25, 32, 40, 51	110	
225	20 do 40	25, 32, 40, 51	110	
250	20 do 40	40, 51, 76	130	
300	32 do 80	76, 127	190	
350	40 do 80	76, 127	215	
400	40 do 80	127, 152.4	230	
450	40 do 100	127, 152.4	290	
500	40 do 160	127, 152.4	290	
600	32 do 160	127, 152.4	290	

F = max. T/2

Brusna plošča F7

$D \times T \times H - P \times F / G$

ravna, poglobitev - obe strani

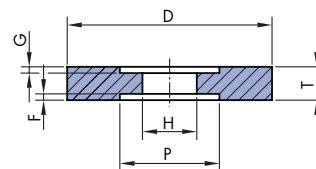

Primer za izpis naročila:

F7 300x50x127-190x15/10

23A46H14/2SVL

D	T	H	P	F,G
200	10 do 32	25, 32, 40, 51	110	
225	20 do 40	25, 32, 40, 51	110	
250	10 do 40	40, 51, 76	130	
300	13 do 80	76, 127	190	
350	16 do 80	76, 127	215	
400	20 do 80	127, 152.4	230	
450	20 do 100	127, 152.4, 203	290	
500	25 do 160	152.4, 203, 305	290	
600	32 do 160	152.4, 203, 305	290	

F+G = max. T/2

Kvaliteta brusnih plošč za zunanje okroglo brušenje

03



Obdelovani material		Kvaliteta
Jekla 	Univerzalno Nekaljeno Kaljena do 62 HRc Kaljena nad 62 HRc Hitrorezna (HSS) Nerjavna	3LA70G5VL 22A60I12/2SVL, 114A46L/M8B 3LA70H16/2SVL, 23A60H16/2SVL 03B91N5VC100, 82A60F18/2SVL 03B91N5VC100, 82A60F18/2SVL, 47A46M8B 22A46G18/2SVL, 47A46J8B
Trdine 	Karbidna trdina	01D126P4VC100, 10C60I6VL
Litine 	Siva Nodularna Jeklana	10C46I6VL, 41A46K6B 90C46I6VL, 41A46K6B 12A36J7VL
Barvne kovine 	Al in zlitine Cu in zlitine	90C46G10/3SVWL, 54A60L5B 90C46G10/3SVWL, 22A30N6B, 50C100F10B
Nekovine 	Plastične mase Guma	90C46H14/2SVWL 90C46G16/2SVWL, 22A40J8B