



## Brusni čepi



PRIMER ZA IZPIS  
NAROČILA:

**OA**

oblika  
brusnega  
čepa

**40A46P4VWL**

kvaliteta  
brusnega  
čepa

**25 x 12 x 6**

premer  
brusnega  
čepa      višina  
premer  
držala

Obdelovani material	40A			22A				3LA			41A				64A	10C	90C
	K	O	P	K	M-W	N-W	P	M	N	O	L	M	N	P	K	F-W	P
<b>Jekla</b> 	Univerzno		••	••						•••							
	Nekaljeno		••						•••					•••			
	Orodno	••	••					•••									
	HSS				••			•••									
	Nerjavno				•••			••			••						
<b>Trdine</b> 	Karbidne															••	
	Stelit											•••					
<b>Litine</b> 	Jeklena											•••					
	Legirana										••			••	•••		
	Siva							••					•••		••		•••
	Nodularna										•••						•••
<b>Barvne kovine</b> 	Al				•••	••	••									•••	
	Cu															••	
	Bron															••	
<b>Ostalo</b> 	Plastika			••												•••	••
	Guma			••												•••	••

••• najbolj primeren

•• primeren

IZBIRA GRANULACIJE JE ODVISNA  
OD PREMERA BRUSNEGA ČEPA:

Premer D (mm)	Velikost zrna	
	Groba	Fina
do 3,9	/	100
od 4 do 7,9	60	100
od 8 do 13,9	46	80
od 14 do 29,9	36	60
nad 30	24	36



## Brusni čepi OA in W

D x T x S x L

brusni čep cilindrični

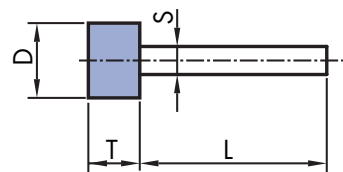

Primer za izpis naročila:

OA 13x13x6

40A46P4VL

Oznaka	DIN EN 68	D	T	S	L
OA 3x3x3	W 143	3	3	3	35
OA 4x2x3	W 148	4	3	3	35
OA 5x3x3	W 151	5	3	3	35
OA 6x3x3	W 158	6	3	3	35
OA 6x5x3	W 159	6	5	3	35
OA 6x6x3	W 160	6	6	3	35
OA 8x3x3	W 166	8	3	3	35
OA 8x6x3	W 167	8	6	3	35
OA 8x8x3	W 168	8	8	3	35
OA 10x3x3	W 173	10	3	3	35
OA 10x6x3	W 174	10	6	3	35
OA 10x10x3	W 175	10	10	3	35
OA 13x3x3	W 182	13	3	3	35
OA 13x6x3	W 183	13	6	3	35
OA 13x10x3	W 184	13	10	3	35
OA 13x13x3	W 185	13	13	3	35
OA 16x3x3	W 191	16	3	3	35
OA 16x4x3		16	4	3	35
OA 16x6x3	W 192	16	6	3	35
OA 16x8x3		16	8	3	35
OA 16x10x3	W 193	16	10	3	35
OA 16x13x6	W 194	16	13	3	35
OA 16x16x6		16	16	3	35
OA 19x3x3	W 200	19	3	3	35
OA 19x6x3	W 201	19	6	3	35
OA 19x10x3	W 202	19	10	3	35
OA 20x4x3		20	4	3	35
OA 20x6x3		20	6	3	35
OA 20x10x3		20	10	3	35
OA 20x13x3		20	13	3	35
OA 20x20x3		20	20	3	35
OA 10x2x6		10	2	6	40
OA 10x2x6		10	2	6	40
OA 10x5x6		10	5	6	40
OA 10x10x6		10	10	6	40
OA 13x3x6	W 182	13	3	6	40
OA 13x6x6	W 183	13	6	6	40
OA 13x10x6	W 184	13	10	6	40
OA 13x13x6	W 185	13	13	6	40
OA 16x3x6	W 191	16	3	6	40
OA 16x4x6		16	4	6	40
OA 16x6x6	W 192	16	6	6	40
OA 16x8x6		16	8	6	40
OA 16x10x6	W 193	16	10	6	40
OA 16x13x6	W 194	16	13	6	40
OA 16x16x6		16	16	6	40
OA 19x3x6	W 200	19	3	6	40
OA 19x6x6	W 201	19	6	6	40
OA 19x10x6	W 202	19	10	6	40
OA 19x13x6	W 203	19	13	6	40
OA 19x19x6	W 204	19	19	6	40
OA 20x6x6		20	6	6	40
OA 20x8x6		20	8	6	40
OA 20x10x6		20	10	6	40
OA 20x13x6		20	13	6	40
OA 20x16x6		20	16	6	40
OA 20x20x6		20	20	6	40
OA 22x3x6	W 211	22	3	6	40

Oznaka	DIN EN 68	D	T	S	L
OA 22x6x6	W 212	22	6	6	40
OA 22x10x6	W 213	22	10	6	40
OA 24x6x6	W 214	24	6	6	40
OA 25x3x6	W 215	25	3	6	40
OA 25x4x6		25	4	6	40
OA 25x6x6	W 216	25	6	6	40
OA 25x10x6	W 217	25	10	6	40
OA 25x13x6	W 218	25	13	6	40
OA 25x16x6		25	16	6	40
OA 25x19x6	W 219	25	19	6	40
OA 25x25x6	W 220	25	25	6	40
OA 32x6x6	W 225	32	6	6	40
OA 32x8x6		32	8	6	40
OA 32x10x6	W 226	32	10	6	40
OA 32x13x6	W 227	32	13	6	40
OA 32x16x6		32	16	6	40
OA 32x20x6		32	20	6	40
OA 32x25x6	W 229	32	25	6	40
OA 32x32x6	W 230	32	32	6	40
OA 38x6x6	W 235	38	6	6	40
OA 38x13x6	W 236	38	13	6	40
OA 38x25x6	W 237	38	25	6	40
OA 38x38x6	W 238	38	38	6	40
OA 40x6x6		40	6	6	40
OA 40x10x6		40	10	6	40
OA 40x13x6		40	13	6	40
OA 40x16x6		40	16	6	40
OA 40x20x6		40	20	6	40
OA 40x25x6		40	25	6	40
OA 40x40x6		40	40	6	40
OA 50x8x6		50	8	6	40
OA 50x10x6		50	10	6	40
OA 50x13x6		50	13	6	40
OA 50x16x6		50	16	6	40
OA 50x20x6		50	20	6	40
OA 50x25x6		50	25	6	40
OA 50x40x6		50	40	6	40
OA 50x50x6		50	50	6	40
OA 20x20x8		20	20	8	40
OA 25x25x8		25	25	8	40
OA 32x25x8		32	25	8	40
OA 32x32x8		32	32	8	40
OA 40x20x8		40	20	8	40
OA 40x32x8		40	32	8	40
OA 40x40x8		40	40	8	40
OA 50x25x8		50	25	8	40
OA 50x40x8		50	40	8	40
OA 20x20x9		20	20	9	40
OA 25x25x9		25	20	9	40
OA 32x25x9		32	25	9	40
OA 32x32x9		32	32	9	40
OA 40x20x9		40	20	9	40
OA 40x32x9		40	32	9	40
OA 40x40x9		40	40	9	40
OA 50x25x9	W 242	50	25	9	40
OA 50x38x9	W 243	50	38	9	40
OA 51x51x9	W 244	51	51	9	40
OA 50x40x9		50	40	9	40



## Brusni čepi

### Brusni čepi OB in W

D x T x S x L

brusni čep cilindrični

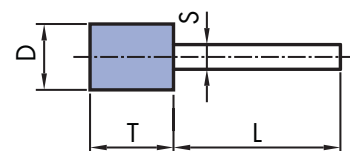

Primer za izpis naročila:

OB 16x40x6

40A46P4VL

Oznaka	DIN EN 68	D	T	S	L
OB 3x6x3	W 144	3	6	3	35
OB 3x10x3	W 145	3	10	3	35
OB 3x13x3	W 146	3	13	3	35
OB 4x6x3	W 149	4	6	3	35
OB 4x8x3		4	8	3	35
OB 4x10x3		4	10	3	35
OB 5x6x3	W 150	5	6	3	35
OB 5x10x3	W 153	5	10	3	35
OB 5x13x3	W 154	5	13	3	35
OB 6x8x3	W 161	6	8	3	35
OB 6x10x3	W 162	6	10	3	35
OB 6x13x3	W 163	6	13	3	35
OB 6x16x3		6	16	3	35
OB 6x19x3	W 164	6	19	3	35
OB 8x10x3	W 169	8	10	3	35
OB 8x13x3	W 170	8	13	3	35
OB 8x16x3		8	16	3	35
OB 10x13x3	W 176	10	13	3	35
OB 10x16x3		10	16	3	35
OB 10x20x3	W 177	10	20	3	
OB 10x25x3	W 178	10	25	3	
OB 12x20x3		12	20	3	
OB 3x6x6		3	6	6	40
OB 4x8x6		4	8	6	40
OB 5x10x6		5	10	6	40
OB 6x10x6		6	10	6	40
OB 6x13x6		6	13	6	40
OB 6x20x6	W 164	6	20	6	40
OB 8x10x6		8	10	6	40
OB 8x13x6		8	13	6	40
OB 8x16x6		8	16	6	40
OB 8x19x6	W 171	8	19	6	40
OB 10x13x6		10	13	6	40
OB 10x19x6	W 177	10	19	6	40
OB 10x25x6	W 178	10	25	6	40
OB 10x32x6	W 179	10	32	6	40
OB 13x16x6		13	16	6	40
OB 13x19x6	W 186	13	19	6	40

Oznaka	DIN EN 68	D	T	S	L
OB 13x25x6	W 181	13	25	6	40
OB 13x32x6		13	32	6	40
OB 13x40x6	W 188	13	40	6	40
OB 13x51x6	W 189	13	51	6	40
OB 16x19x6	W 195	16	19	6	40
OB 16x25x6	W 196	16	25	6	40
OB 16x32x6		16	32	6	40
OB 16x40x6		16	40	6	40
OB 16x50x6	W 197	16	50	6	40
OB 16x63x6	W 198	16	63	6	40
OB 19x19x6	W 205	19	25	6	40
OB 19x19x6	W 207	19	38	6	40
OB 19x19x6	W 208	19	51	6	40
OB 19x19x6	W 209	19	64	6	40
OB 20x25x6		20	25	6	40
OB 20x32x6		20	32	6	40
OB 20x40x6		20	40	6	40
OB 20x50x6		20	50	6	40
OB 22x50x6		22	50	6	40
OB 25x32x6		25	32	6	40
OB 25x38x6	W 221	25	38	6	40
OB 25x40x6		25	40	6	40
OB 25x50x6	W 222	25	50	6	40
OB 25x63x6	W 223	25	63	6	40
OB 32x40x6		32	40	6	40
OB 32x50x6		32	50	6	40
OB 20x25x 8		20	25	8	40
OB 25x32x8		25	32	8	40
OB 32x40x8	W 231	32	40	8	40
OB 32x50x8	W 232	32	50	8	40
OB 40x45x8		40	45	8	40
OB 20x25x6		20	25	9	40
OB 25x32x6		25	32	9	40
OB 32x40x6		32	40	9	40
OB 32x63x6	W 233	32	63	9	40
OB 32x50x6		32	50	9	40
OB 38x51x6	W 239	38	51	9	40
OB 40x45x6		40	45	9	40



## Brusni čep OC

D x T x S x L

brusni čep cilindrični - krožni

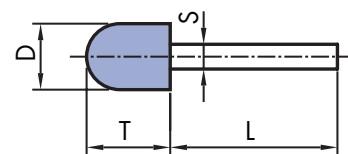

Primer za izpis naročila:

OC 16x20x6

11A60P4VL

Oznaka	D	T	S	L
OC 3x6x3	3	6	3	35
OC 6x10x3	6	10	3	35
OC 8x16x3	8	16	3	35
OC 13x16x3	13	16	3	35
OC 3x6x6	3	6	6	40
OC 6x10x6	6	10	6	40
OC 8x16x6	8	16	6	40
OC 13x9x6	13	19	6	40
OC 16x20x6	16	20	6	40
OC 20x25x6	20	25	6	40

## Brusni čep OD

D x T x S x L

brusni čep konični - krožni

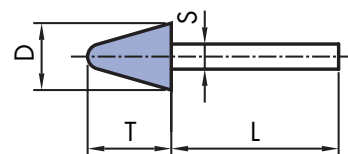

Primer za izpis naročila:

OD 16x32x6

3LA80MPVL

Oznaka	D	T	S	L
OD 6x10x3	6	10	3	35
OD 10x10x3	10	10	3	35
OD 10x12x3	10	12	3	35
OD 6x10x6	6	10	6	40
OD 10x10x6	10	10	6	40
OD 10x12x6	10	12	6	40
OD 10x25x6	10	25	6	40
OD 12x16x6	12	16	6	40
OD 16x16x6	16	16	6	40
OD 16x32x6	16	32	6	40
OD 16x40x6	16	40	6	40
OD 20x20x6	20	20	6	40
OD 20x25x6	20	25	6	40
OD 20x32x6	20	32	6	40
OD 20x40x6	20	40	6	40
OD 25x25x6	25	25	6	40
OD 25x32x6	25	32	6	40
OD 25x70x6	25	70	6	40
OD 32x32x6	32	32	6	40
OD 32x50x6	32	50	6	40



## Brusni čepi

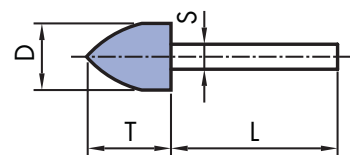

### Brusni čep OE

D x T x S x L

brusni čep zaokroženo - koničasti

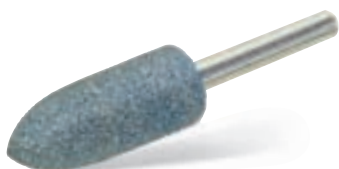

Oznaka	D	T	S	L
OE 3x6x3	3	6	3	35
OE 5x10x3	5	10	3	35
OE 6x10x3	6	10	3	35
OE 8x16x3	8	16	3	35
OE 10x20x3	10	20	3	35
OE 12x16x3	12	16	3	35
OE 12x20x3	12	20	3	35
OE 3x6x6	3	6	6	40
OE 6x10x6	6	10	6	40
OE 8x16x6	8	16	6	40
OE 10x20x6	10	20	6	40
OE 12x20x6	12	20	6	40
OE 16x32x6	16	32	6	40
OE 16x40x6	16	40	6	40
OE 20x32x6	20	32	6	40
OE 20x40x6	20	40	6	40
OE 20x50x6	20	50	6	40
OE 25x40x6	25	40	6	40

Primer za izpis naročila:

OE 12x20x6

13A46P4VL

### Brusni čep OF

D x T x S x L

brusni čep lončasti - konični

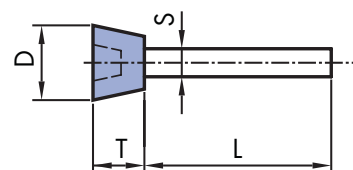

Oznaka	D	T	S	L
OF 20x16x6	20	16	6	40
OF 25x16x6	25	16	6	40
OF 25x20x6	25	20	6	40
OF 32x25x6	32	25	6	40
OF 40x32x6	40	32	6	40

Primer za izpis naročila:

OF 32x25x6

40A46P4VL

### Brusni čep OG

D x T x S x L

brusni čep konični

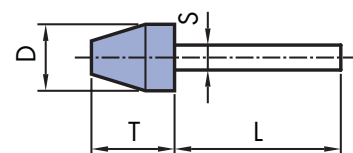

Oznaka	D	T	S	L
OG 08x25x6	8	25	6	40
OG 10x20x6	10	20	6	40
OG 13x20x6	13	20	6	40
OG 13x32x6	13	32	6	40
OG 16x40x6	16	40	6	40
OG 20x25x6	20	25	6	40
OG 20x32x6	20	32	6	40
OG 25x32x6	25	32	6	40
OG 25x70x6	25	70	6	40
OG 32x40x6	32	40	6	40

Primer za izpis naročila:

OG 16x40x6

40A46P4VL



## Brusni čep OH

D x S x L

brusni čep kroglica

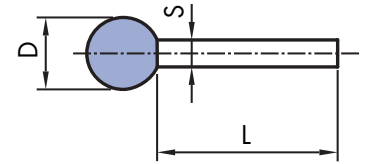
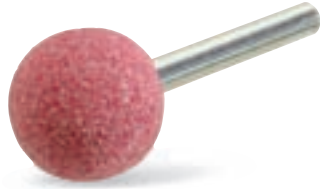

Oznaka	D	S	L
OH 3x3	3	3	35
OH 6x3	6	3	35
OH 8x3	8	3	35
OH 10x3	10	3	35
OH 12x3	12	3	35
OH 3x6	3	6	40
OH 6x6	6	6	40
OH 8x6	8	6	40
OH 10x6	10	6	40
OH 13x6	13	6	40
OH 16x6	16	6	40
OH 20x6	20	6	40
OH 25x6	25	6	40
OH 32x6	32	6	40
OH 40x6	40	6	40
OH 32x9	32	9	40
OH 40x9	40	9	40
OH 50x9	50	9	40

Primer za izpis naročila:

OH 13x6

40A60P4VL

## Brusni čep OI

D x T x S x L

brusni čep kaplja

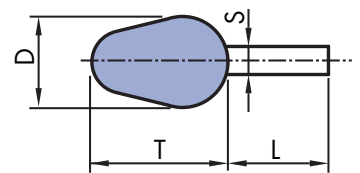
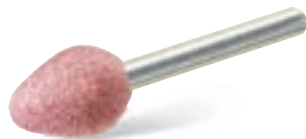

Primer za izpis naročila:

OI 20x25x6

40A46P4VL

Oznaka	D	T	S	L
OI 20x25x6	20	25	6	40

## Brusni čep OJ

D x T x S x L

brusni čep z navojnim držalom

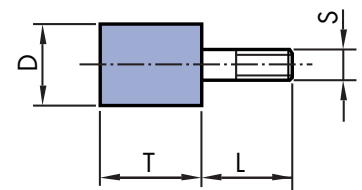

Primer za izpis naročila:

OJ 20x25xM6x10

41A46P4VL

Oznaka	D	T	S	L
OJ 9,5x10xM5x12	9,5	10	M5	12
OJ 10,5x13xM4x12	10,5	13	M4	12
OJ 13x13xM4	13	13	M4	14



# Brusni čepi



## SKUPINA A ISO 2933

premer trna 6 mm

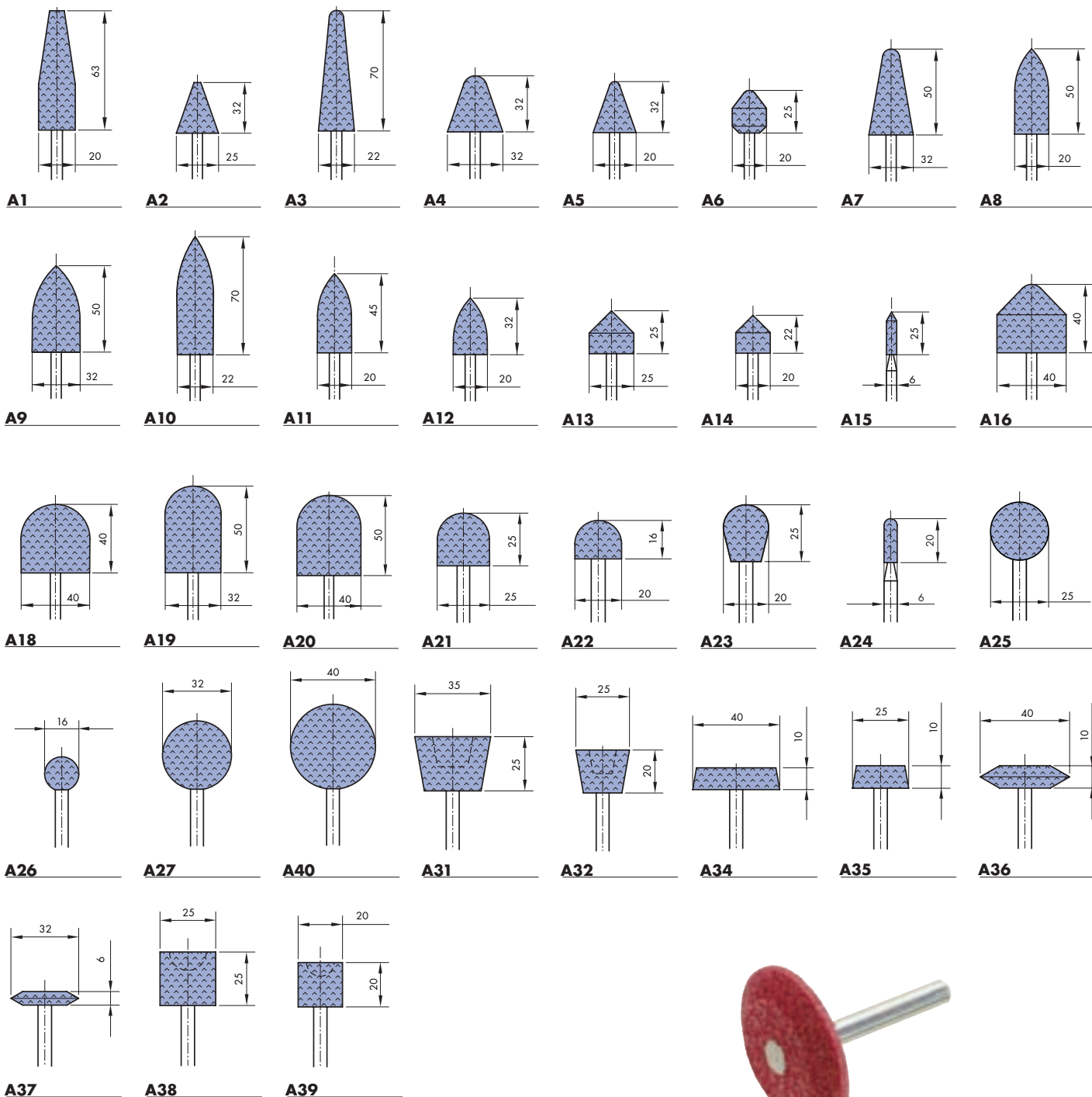

Primer za izpis naročila:  
A20  
40A46P4VL

