



Ploskovno in profilno brušenje z obodom brusne plošče

Brusna plošča F1

$D \times T \times H$

ravna brusna plošča

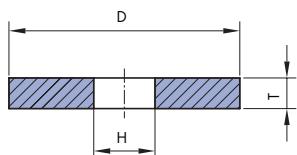

Primer za izpis naročila:

F1 300x30x127

82A46/3G16/3SV12L

D	T	H
100	10 do 32	10, 13, 16, 20, 25, 32
125	10 do 32	13, 16, 20, 25, 32, 40
150	10 do 32	13, 16, 20, 25, 32, 40
200	10 do 32	13, 16, 20, 25, 32, 40, 51
225	10 do 32	16, 20, 25, 32, 40, 50, 60
250	10 do 32	20, 25, 32, 40, 51, 76
300	10 do 50	32, 40, 51, 76, 127
350	16 do 50	32, 40, 51, 76, 127, 151
400	20 do 80	40, 51, 76, 127, 152.4, 203
450	20 do 80	76, 127, 152.4, 203,
500	25 do 160	76, 127, 152.4, 203
600	32 do 160	127, 152.4, 203, 305

Brusna plošča F5

$D \times T \times H - P \times F$

ravna, poglobitev - ena stran

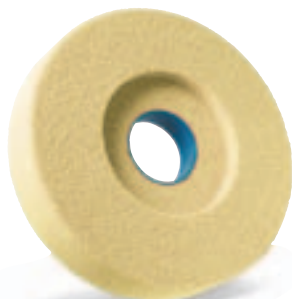
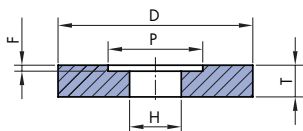

Primer za izpis naročila:

F5 300x50x127-200x20

3LA60H16/2SV12L

D	T	H	P	F
100	10 do 32	25, 32, 40	60	
125	10 do 32	25, 32, 40, 51	75	
150	25 do 32	25, 32, 40, 51	75	
200	25 do 32	25, 32, 40, 51	110	
225	20 do 40	25, 32, 40, 51	110	
250	20 do 40	40, 51, 76	130	
300	32 do 80	76, 127	190	
350	40 do 80	76, 127	215	
400	40 do 80	127, 152.4	230	
450	40 do 100	127, 152.4	290	
500	40 do 160	127, 152.4	290	
600	32 do 160	127, 152.4	290	

F = max. T/2

Brusna plošča F7

$D \times T \times H - P \times F / G$

ravna, poglobitev - obe strani

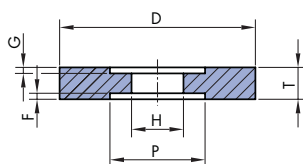

Primer za izpis naročila:

F7 300x50x127-100x15/10

23A46H18/4VV12L





D	T	H	P	F,G
100	10 do 32	25, 32, 40	60	
125	10 do 32	25, 32, 40, 51	75	
150	10 do 32	25, 32, 40, 51	75	
200	10 do 40	25, 32, 40, 51	110	
225	20 do 40	25, 32, 40, 51	110	
250	10 do 40	40, 51, 76	130	
300	13 do 80	76, 127	190	
350	16 do 80	76, 127	215	
400	20 do 80	127, 152.4	230	
450	20 do 100	127, 152.4, 203	290	
500	25 do 160	152.4, 203, 305	290	
600	25 do 160	152.4, 203, 305	290	

F+G = max. T/2

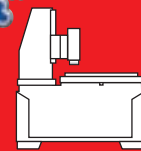
Kvaliteta brusnih plošč za ploskovno in profilno brušenje

01



Obdelovani material		Kvaliteta
Jekla 	Univerzalno Nekaljeno Kaljena do 62 HRc Kaljena nad 62 HRc Hitrorezna (HSS) Nerjavna Nitirana	3LA60H1V6/2SV12L 3LA60H16/2SV12L , 12A46I14/2SV12L 3LA60H16/2SV12L , 23A46H18/4VV12L 03B126N14/1SVC75, 3SA46H18/3VV12L, 82A46/3G16/3SV12L 62A46G16/2SV12L, 82A46/3G16/2SV12L 22A46H18/4VV12L 10C46H14/2SV12L, 82A46I14/2SV12L
Trdine 	Karbidna trdina	01D126N6VC75, 10C60J6VL
Litine 	Siva Nodularna Jeklena	90C46J6VL 90C46J6VL 12A46J7VL
Barvne kovine 	Al in zlitine Cu in zlitine	90C46G10/3SV16WL 90C46G10/3SV16WL
Nekovine 	Plastične mase Guma	90C46G16 /2SVWL 90C46G16/2SVWL

