

GRINDING WHEELS – Railway product range



These grinding wheels are intended for the maintenance of railway tracks and for the grinding of welds and switches on special, purpose-built machines. They are distinguished by high durability and good grinding effects per time unit without workpiece overheating.

QUALITY	HARDNESS	PROPERTIES	QUALITY CLASS
12A14-24-B	P-U	Good durability	Standard
ZA14-24-B	P-U	High durability	Special

Type	Dimensions D x T x H mm	Peripheral speed m/s	Rpm 1/min	Packaging units
F1	150 x 25 x 20 (16)	50	6400	2
F1-AF	230 x 15 x 25.4 (22.23)	50	4200	5
F1-AF	230 x 15 x 22.23 (25.4)	63	5250	
F1	230 x 20 x 25.4 (22.23)	50	4200	
F1-AF	230 x 20 x 22.23 (25.4)	63	5250	
F1-AF	254 x 15 x 25.4	63	4850	
F1	254 x 30 x 25.4	50	3850	2
F1-AF	260 x 15 x 120	50	3650	5
F1-AF	260 x 15 x 120	63	4650	
F1	260 x 25 x 120	50	3650	2
F1-AF	300 x 25 x 120	63	4050	
F5	254 x 32 x 25.4/152 x 13	50	3850	1
F5	254 x 38 x 25.4/127 x 12	50	3850	
F5	300 x 40 x 120/230 x 25	50	3200	
F6-MK	94 x 85 x M20 W21;E20	50	10150	10
F6-MK	100 x 100 x M20 W20;E23	50	9550	
F6-MK	100 x 110 x M20 W25;E23	50	9550	
F6-MKKR	152 x 80 x M20(5/8") W50;E18	63	8050	4
F7	135 x 95 x 25.4/2 x 55 x 32.6	50	7100	1
F7	254 x 32 x 25.4/2 x 152 x 13	50	3850	
F7	254 x 40 x 76/2 x 166 x 10	50	3850	

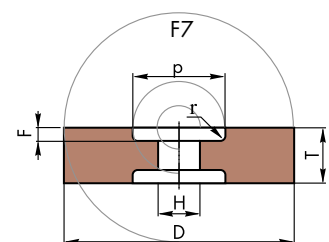
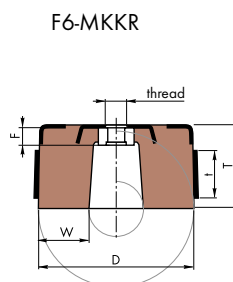
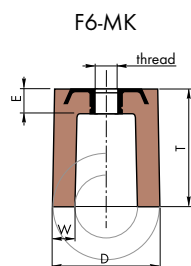
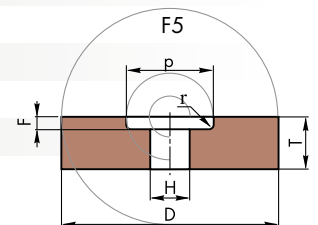
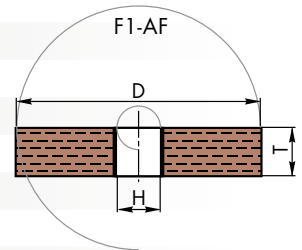
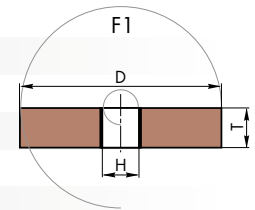

M20 nuts can be produced with left or right threads.



QUALITY	HARDNESS	PROPERTIES	QUALITY CLASS
12A14-24-B	P-U	Good durability, good grinding efficiency and no overheating of workpiece surface	Standard
ZA14-24-B	P-U	Very high durability, high grinding efficiency and no overheating of workpiece surface	Special

Type	Dimensions D x T x H mm	Peripheral speed m/s	Rpm 1/min	Packaging units
F35	180 x 105 x 90	50	5350	1
F35	250 x 75 x 150	50	3850	
F36	250 x 76 x 150 Aluminium flange	50	3850	
F36	260 x 35 x 195 Aluminium flange	50	3700	
F37	130 x 60 x 57 (4 x M8/10) Dk=90	50	7350	
F37	150 x 75 x 57 (4 x M8/15) Dk=90	50	6400	
F37	152 x 79 x 80 (6 x M8/20) Dk=115			

