

GRINDING CUPS

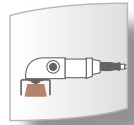

Grinding cups are intended for the grinding of large surface areas of materials with manual angle grinding machines. Please note that grinding cups are **NON-REINFORCED** and therefore highly sensitive to mechanical damage, which may result from impacts or equipment falling on the floor.

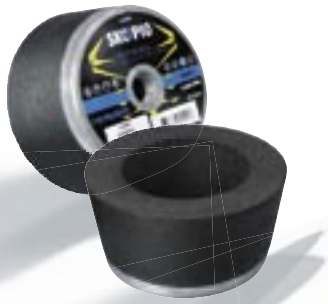

Grinding cups should **ALWAYS** be fastened on angle grinding machines using a special safety shield!

QUALITY	HARDNESS	MATERIAL	QUALITY CLASS
A14-A120-B	M-R	Metals, steel, construction steel	Standard
19A14-19A36-B	M-R	Grey cast	Standard
47A14-47A46-B	P-R	Stainless steel, steel, alloys	Special
ZA14-ZA4-B	P-R	Stainless steel, steel, alloys	Special
C14-C120-B	N-R	Concrete, stone, granite	Standard

Type	Dimensions D x T x H mm	J mm	W mm	E mm	Peripheral speed m/s	Rpm 1/min	Packaging units
F11-P	102/76 x 51 x 22.23	76	12	12		9370	
F11-P	110/90 x 55 x 22.23	90	20	12		8680	
F11-P	130/90 x 55 x 22.23	90	30	12		7350	5
F11-MP	76/64 x 40 x thread	64	12	11		12570	10
F11-MP	102/76 x 51 x thread	76	20	12/19		9370	
F11-MP	110/90 x 55 x thread	90	20	12/19		8680	
F11-MP	130/90 x 55 x thread	90	30	12/19		7350	5
F11-MK	130/90 x 55 x thread	90	30	12		7350	
F11-MK	130/100 x 51 x thread	100	30	19		7350	
F11-MK	150/120 x 51 x thread	120	30	19		6400	



Threads: M10, M14, 5/8"UNC

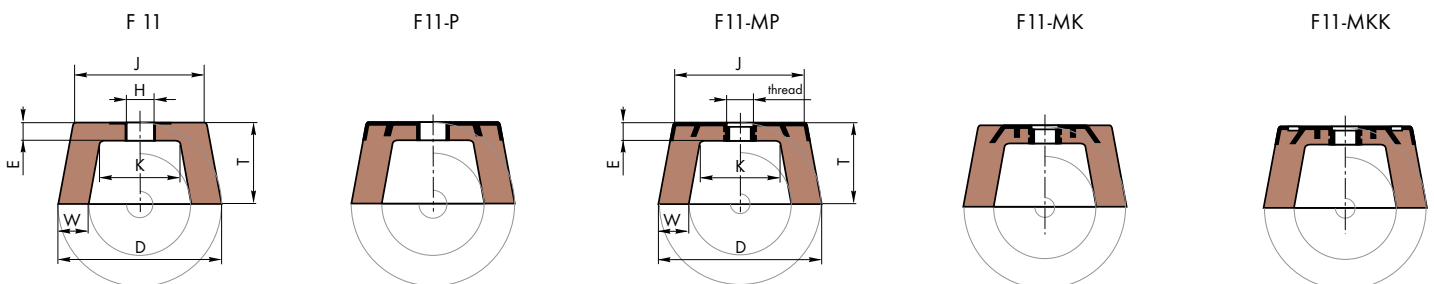

On customer request, F11 grinding cups can be made without flange.

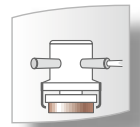

The F6 and F6-MK grinding cups are intended for grinding large surface areas with manual vertical grinding machine.

QUALITY	HARDNESS	MATERIAL	QUALITY CLASS
A14-A120-B	M-R	Metals, steel, construction steel	Standard
19A14-19A36-B	M-R	Grey cast	Standard
47A14-47A46-B	P-R	Stainless steel, steel, alloys	Special
ZA14-ZA46-B	P-R	Stainless steel, steel, alloys	Special
54A14-54A46-B	P-R	Aluminium	Standard
C14-C120-B	N-R	Concrete, stone, granite	Standard

Type	Dimensions	W mm	E mm	Peripheral speed m/s	Rpm 1/min	Packaging units
	D x T x H mm					
F6	80 x 45 x 22.23	18	12	50	11940	10
F6	100 x 45 x 22.23	28	12		9550	
F6	130 x 50 x 22.23	32	12		7350	5
F6	130 x 110 x 22.23	35	20		6370	
F6	150 x 40 x 22.23	35	12		6370	1
F6	150 x 50 x 22.23	35	12		6370	
F6	150 x 110 x 22.23	35	20		6370	
F6-MK	80 x 45 x M14	20	12		11940	10
F6-MK	100 x 45 x M14	30	12		9550	
F6-MK	130 x 50 x M14	32	12		7350	5
F6-MK	130 x 65 x M14	35	15	7350		
F6-MK	150 x 40 x M14	50	19	6370	1	
F6-MK	150 x 50 x M14	50	19	6370		
F6-MK	150 x 55 x M20	40	19	6370		
F6-MK	150 x 65 x 5/8"-11	40	19	6370		

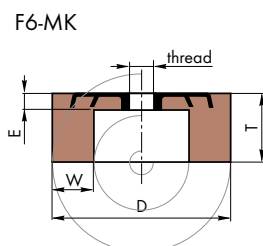
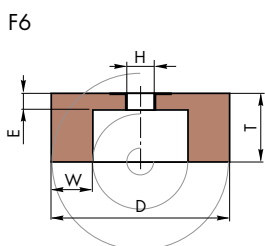
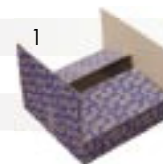

On customer request, F6 grinding cups can be made without flange.



GRINDING CUPS

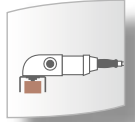

Grinding cups with spiral top for fastening are intended for the grinding of large surface areas. Please note that they are not reinforced and therefore highly sensitive to mechanical damage, which may result from impacts or equipment falling on the floor.

QUALITY	HARDNESS	MATERIAL	QUALITY CLASS
A14-A120-B	M-R	Metals, steel, construction steel	Standard
19A14-19A36-B	M-R	Grey cast	Standard
47A14-47A46-B	P-R	Stainless steel, steel, alloys	Special
ZA14-ZA46-B	P-R	Stainless steel, steel, alloys	Special
54A14-54A46-B	P-R	Aluminium	Standard
C14-C120-B	N-R	Concrete, stone, granite	Standard

Type	Dimensions D x T x H mm	W mm	Peripheral speed m/s	Rpm 1/min	Packaging units
F35-SGD	100 x 40 x 32	34	35	6690	10
F35-SGD	130 x 40 x 58	35		5140	
F35-SGD	150 x 40 x 58	33		4460	
F35-SGL	100 x 40 x 32	34		6690	
F35-SGL	130 x 40 x 58	35		5140	
F35-SGL	150 x 40 x 58	35		4460	



F35-SGD

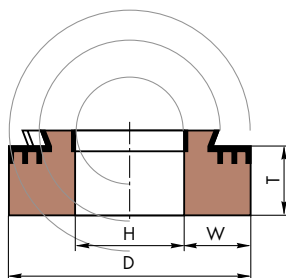

F35-SGL

